



Iron Horse Vineyard

April 11, 2013

BazzanoMapping

- Air Vent
- Valve
- W Water Tank
- Well Head

Vineyard Blocks - 156.3 ac.

- Chardonnay - 64.3 ac.
- Pinot noir - 91.8 ac.

B north
 8.11 Acres
 7,847 vines
 Pinot - C:777-667
 R: 101-14
 9x5
 90°-270°

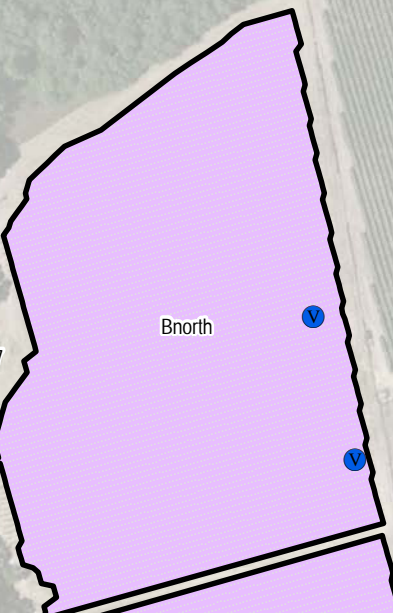

B south
 4.83 Acres
 5,264 vines
 Pinot - C:115
 R: 110R
 8x5
 90°-270°

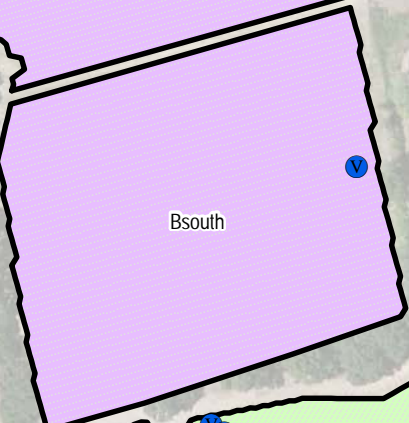

Cd-E
 3.79 Acres
 5,901 vines
 Ch - C:Wente
 R: 420A
 7x4
 30°-210°



Train Barn
 2.69 Acres
 4,191 vines
 Ch - C:Rued Z
 R: 420A
 7x4
 30°-210°



Cd-E

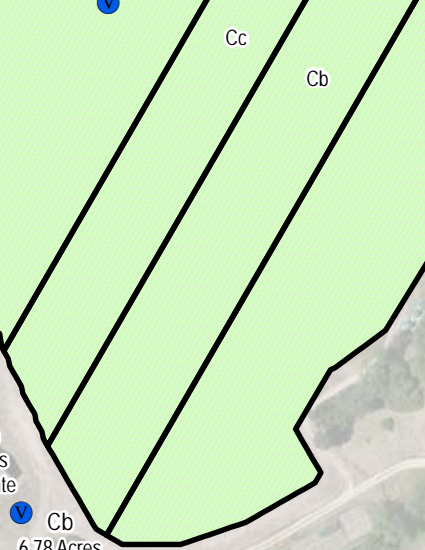

Ca
 6.01 Acres
 9,350 vines
 Ch - C:Wente
 R: 420A
 7x4
 30°-210°

Z
 1.89 Acres
 2,936 vines
 Ch - C:Rued Z
 R: 420A
 7x4
 150°-330°

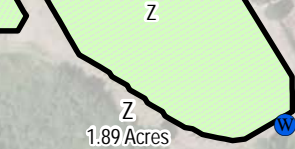

Cc
 3.2 Acres
 4,978 vines
 Ch - C:Wente
 R: 420A
 7x4
 30°-210°

Cb
 6.78 Acres
 10,548 vines
 Ch - C:Wente
 R: 420A
 7x4
 30°-210°

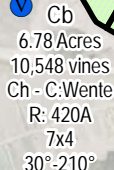
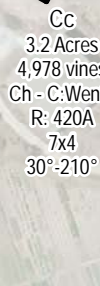

Upper A
 2.21 Acres
 3,445 vines
 Ch - C:Rued Z
 R: 420A
 7x4
 150°-330°

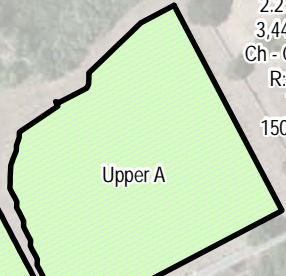

Lower A
 3.2 Acres
 4,978 vines
 Ch - C:Rued Z
 R: Riperia
 7x4
 150°-330°

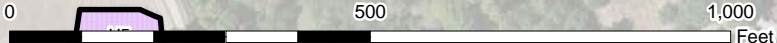
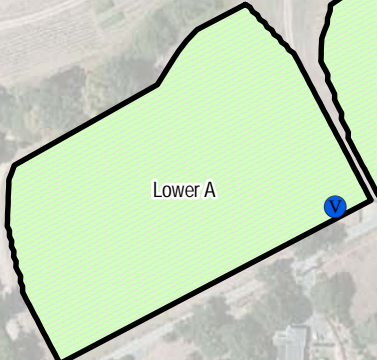

H3